

## Visitor Center 'Gärten der Welt', Berlin (GER)

Project	<b>Construction of the new visitor center for the horticulture exhibition 2017 including areas for gastronomy, exhibition and events</b>
Client	<b>Grün Berlin GmbH (GER) / public client</b>
Award	<b>1st prize, international competition</b>
services	<b>WW+, Esch-sur-Alzette (LUX) / Trier (GER) architecture HOAI LPH 1-9</b>
Shop/Gastronomy	Moniteurs, Berlin (GER)
Open space	geskes.hack Landschaftsarchitekten, Berlin (GER)
civil eng.	IKP Industrie-Konstruktion+ Planung, Pinneberg (GER) / Prof. Dr.- Ing. Hilbers Ingenieurgesellschaft, Berlin (GER)
Technical eng.	Ingenieurbüro für TGA - Dipl.-Phys. H.-J. Rehberg, Berlin (GER)
Infrastructure	BEV Ingenieure, Königs Wusterhausen (GER) IfE grothe, Berlin (GER)
Hvac	Heimann Ingenieure, Berlin (GER)
Acoustics	Ritter Bauphysik, Postdam (GER)
Building physics	Andreas Wilke - Ing. - Büro f. Bauph. u. Baukonstr., Postdam (GER)
Fire protection eng.	GSE Ing.-Gesellsch. mbH Saar, Enseleit und Partner, Berlin (GER)

Photographs Stefan Müller, Berlin (GER) / Sven-Erik Tornow / alwitra

- Facts
- **funded by european subsidies**
  - **barrier free building according to german standards 'Bau Bln § 52 Barrierefreies Bauen'**
  - **Berlin - Design for all**

Publications

**Wettbewerbe Aktuell (07/2013 + 07/2017)**  
**Gründach Aktuell (02/2016)**  
**DESIGN FIRST-BUILD SMART (2017)**  
**STEIN (05/2017)**  
**Berlin wird blumIGA. (2017)**  
**Archiduc (14/2017)**  
**Revue Technique (02/2017)**  
**bba (01-02/2018)**

Dates and numbers

gfa	<b>2.462 m<sup>2</sup></b>
ufa	<b>2.021 m<sup>2</sup></b>
gv	<b>13.223 m<sup>3</sup></b>
total area	<b>2,1 ha</b>
net construction c.	<b>4.852.361 €</b>
total gross costs	<b>5.773.880 €</b>
competition phase	<b>02/2013 - 04/2013</b>
start of planning	<b>02/2013</b>
realisation	<b>12/2014 - 04/2017</b>



figure ground plan



site plan

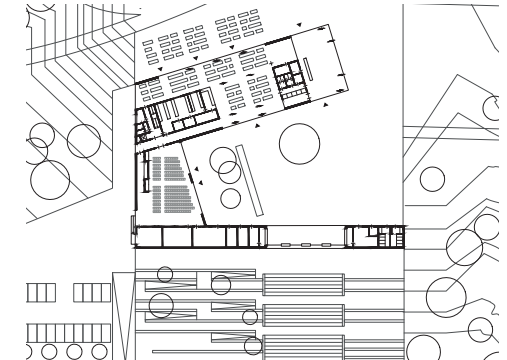

ground floor





*"All that is against nature cannot last in the long run."*  
Charles Darwin

The unique geology and geography of the Gardens of the World is what characterises the overall sculptural and typological structure of the planned visitor centre. The architectural concept, the staging of the individual functional units and the design of the outdoor facilities all systematically descend from the existing natural environment.

#### URBAN PLANNING CONCEPT | DESIGN CONCEPT

Genius Loci – visitor centre in the flow of nature

The distinctiveness of the site at the entrance of a scenic landscape and on the fringes of a garden-city residential area provides only limited urban planning specifications. The result is a basic concept of the visitor centre emanating from the flow of nature.

The architectonic concept foresees a compact building form, in a bid to reduce the built-up surfaces in favour of a green setting. It places particular emphasis on a harmonious integration into the surrounding natural environment. Given its distinctive form, the building forms a clear, identity-establishing conclusion to the Blumberger Damm, while also opening onto the Gardens of the World recreational park with its unique and extensive expression, which rises with the landscape. The green inner courtyard and the vast open forecourt create a flow between the visitor centre and the existing natural and green environment.

The visitor centre, with its clearly defined structure, provides visitors with a warm and secure welcome from an urban to a natural setting. At the same time, openness and transparency are achieved through the targeted use of materials, light and openings.

